

PLEASE RECYCLE

IF THIS IS NOT 24"X36", IT IS A REDUCED PRINT - SCALE ACCORDINGLY

7/10/2019 7:41:10 AM

3

Dem



KEYNOTES	
201	ADD 3M SAFETY FILM TO ALL WINDOWS (INTERIOR SIDE), TYP.
202	ADD ONE WAY VISIBILITY PRIVACY WINDOW FILM TO ALL WINDOWS (EXTERIOR SIDE), TYP.
203	DEMO AND EXPAND EXISTING CASEWORK.
204	DEMO EXISTING CASEWORK AND PARTITION WALLS IN ROOM D09.
205	REPLACE COVER TO EXISTING FLOOR MOUNTED MECHANICAL ENCLOSURES TO ALLOW FOR MORE AIR FLOW (17"X14" TYP.
206	ADD VISION PANEL TO EXISTING BEDROOM DOORS.
207	INSTALL RECESSED BOTTLE FILLER AT EXISTING WATER LINE IN DAY ROOM.
208	CAP ALL ELECTRICAL AND DATA OUTLETS IN BEDROOMS, TYP.
209	REPLACE EXISTING LANDSCAPE GRATES (X46) TO ANTI-SLIP/LITERATURE GRATE.
210	REMOVE BENCH AND BRICK WALL (L2).
211	REPLACE MISSING TOILET SCREWS AT ALL BEDROOM PLUMBING FIXTURES.
212	REPLACE DRAIN COVER AT SHOWER ENCLOSURES WITH ANTI-SLIP/LITERATURE OPTION.
214	ADD PARKING SIGNAGE FOR PUBLIC PARKING.
215	DEMO CASEWORK AND PARTITION AT DAY ROOM.
216	RELOCATE DOUBLE DOORS FROM SECOND FLOOR TO FIRST FLOOR.
217	DEMO EXISTING CASEWORK AND PARTITION WALLS IN ROOM C20.
218	INSTALL RECESSED BOTTLE FILLER IN DAY ROOM.
222	LAUNDRY TO REMAIN AND SERVE UNIT BELT PHASE 2 IS COMPLETE.
223	INSTALL WINDOW AT EXTERIOR WALL TO SERVE NEW 3 BEDROOM.
225	DEMO EXISTING BRICK WALL.
226	CONVERT EXISTING PHARMACY ROOM TO LAUNDRY ROOM.
228	UTILIZE AS PUBLIC ENTRANCE.
229	BUILD A FENCE/BARRIER AROUND EXISTING EQUIPMENT.
231	REMOVE EXISTING CURTAINS FROM WINDOWS, TYP.

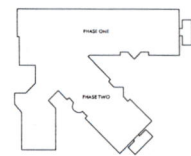

ARCHITECTURAL  
RESOURCE  
TEAM  
1055 e Indian school rd  
phoenix, az 85014  
602-307-5399 | v  
www.art-team.com

RECOVERY INNOVATIONS  
Fayetteville TI  
1724 Roxie Ave  
Fayetteville, NC 28304

Schematic Design

Revision Schedule		
No.	Date	Description

19035	APP PROJECT NO.
07/10/19	DATE
BC	DESIGNER
DP	DRAWN BY

PRELIMINARY  
NOT FOR  
CONSTRUCTION

Unnamed

A9.11

3